

# L'ENSEIGNEMENT DU VERNACULAIRE

## Expériences et projets en Valais

Une exposition des travaux de relevé des  
étudiant(e)s en architecture de l'EPFL

cahier de dessins **n°5**

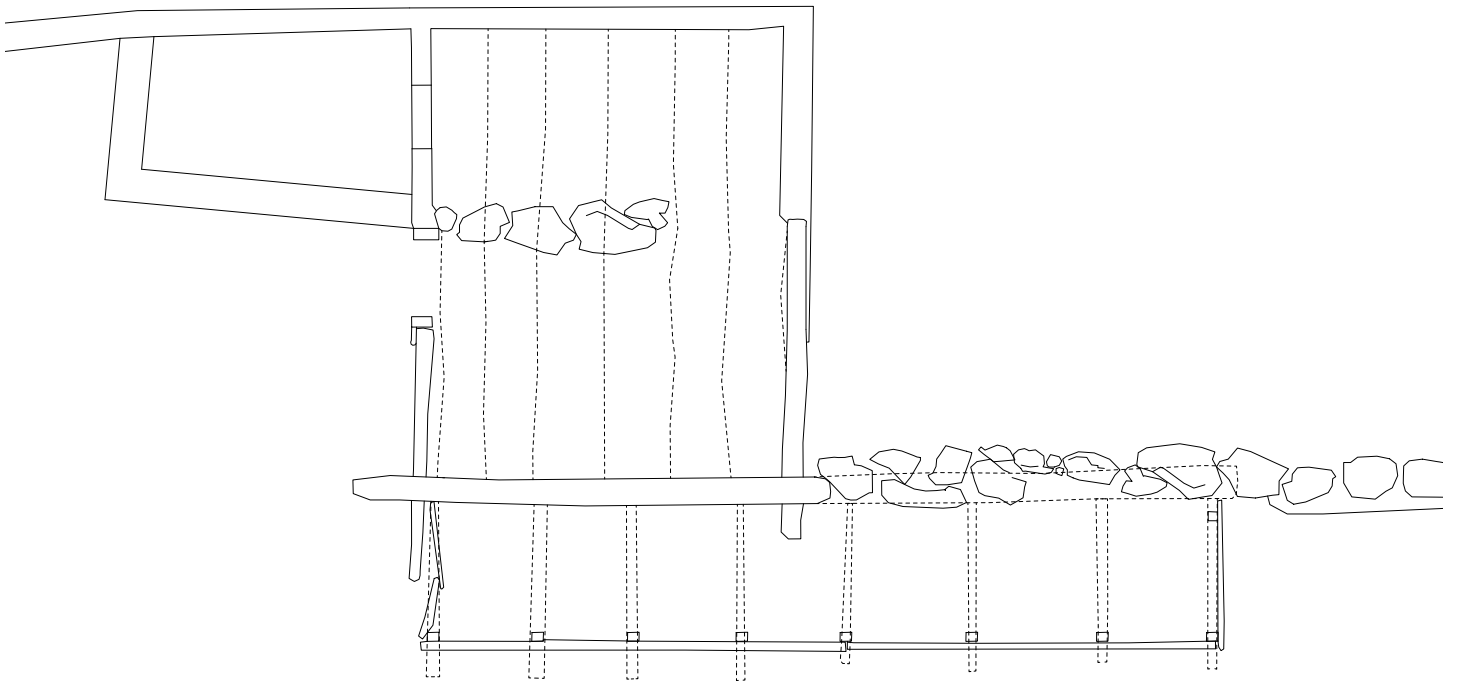

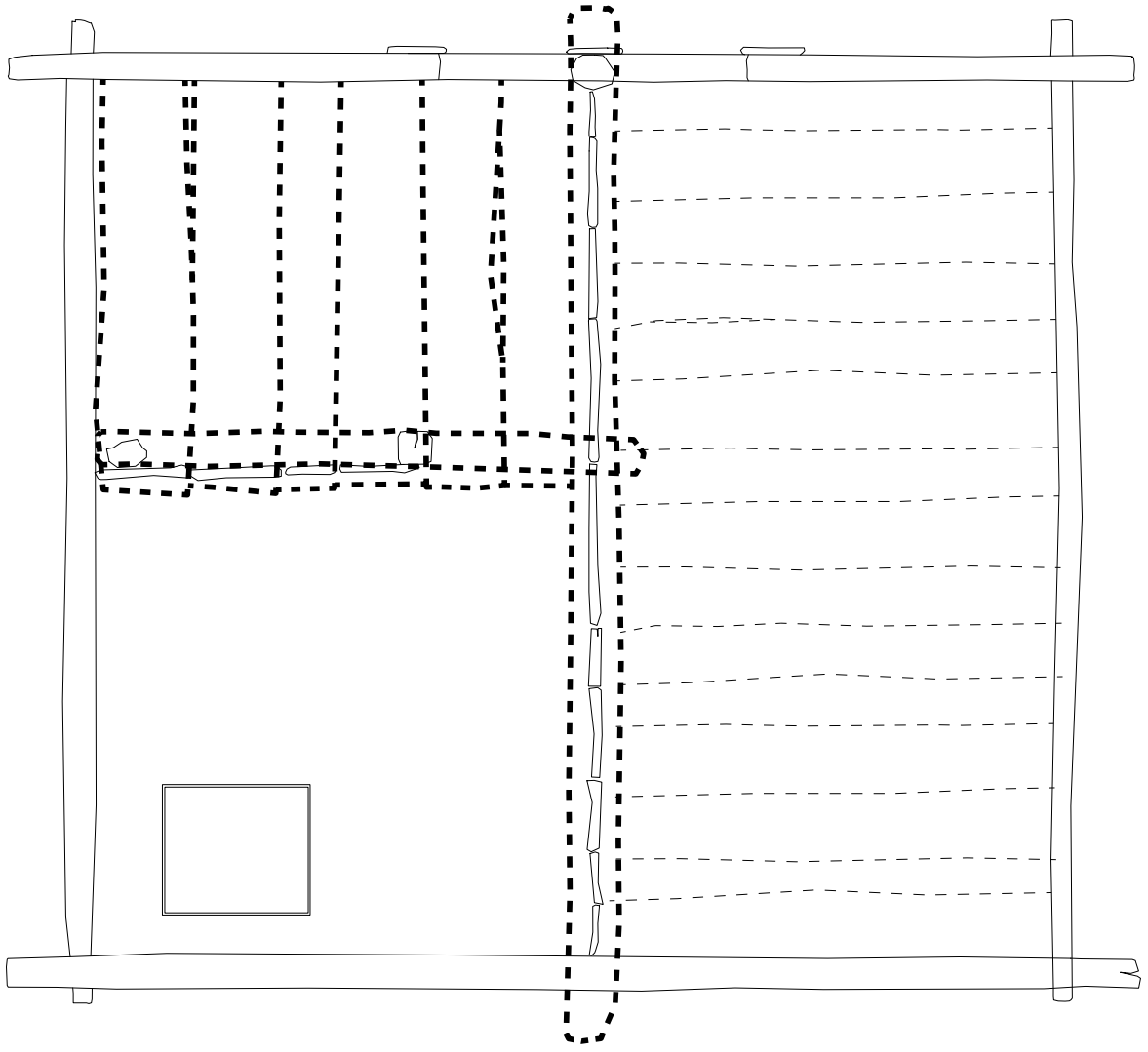

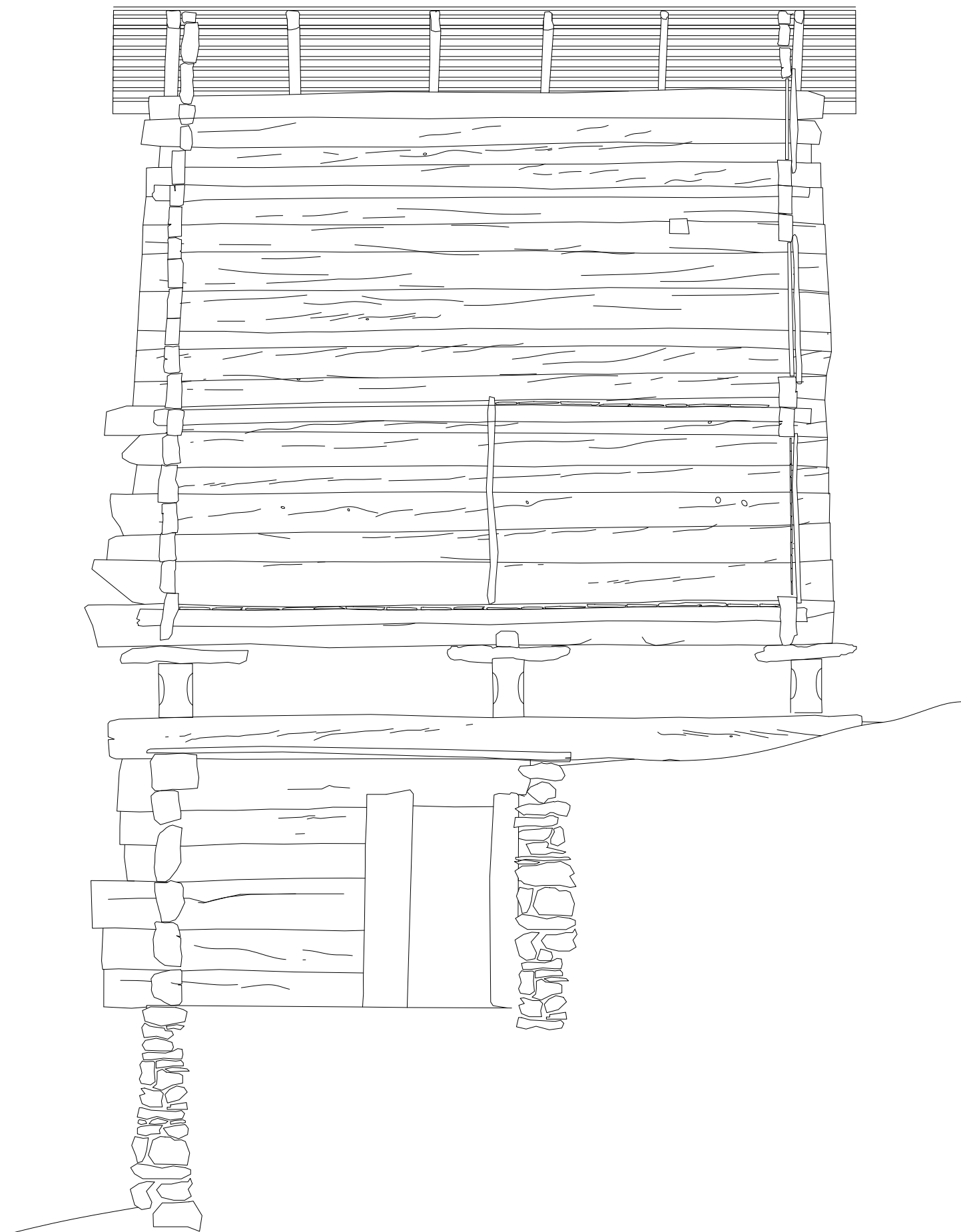

Isérables

Groupe 22, Arko Naroyan, François Loison, Andrea Ishii, Philippe Audemard d'Alançon

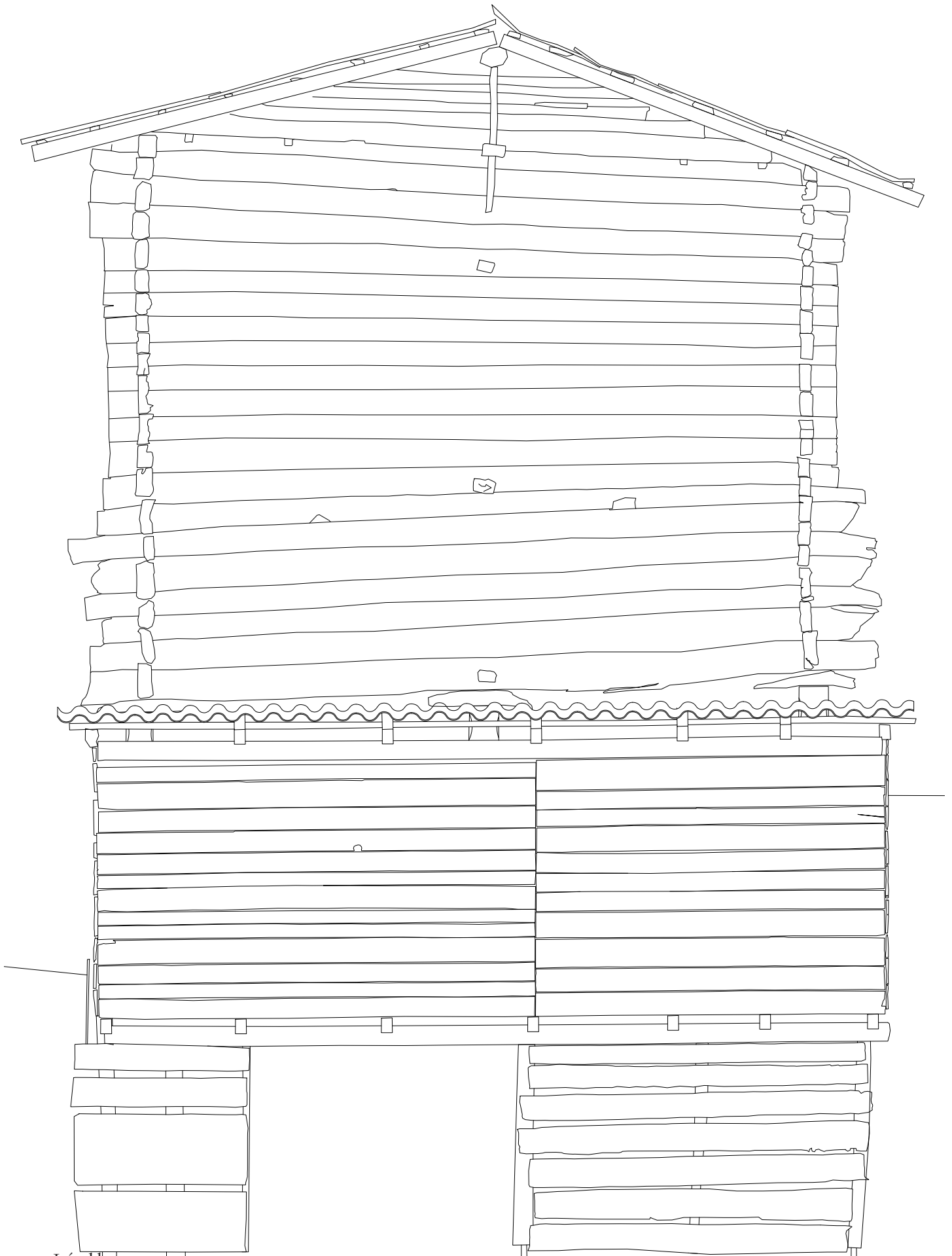

Isérables

Groupe 22, Arko Naroyan, François Loison, Andrea Ishii, Philippe Audemard d'Alançon

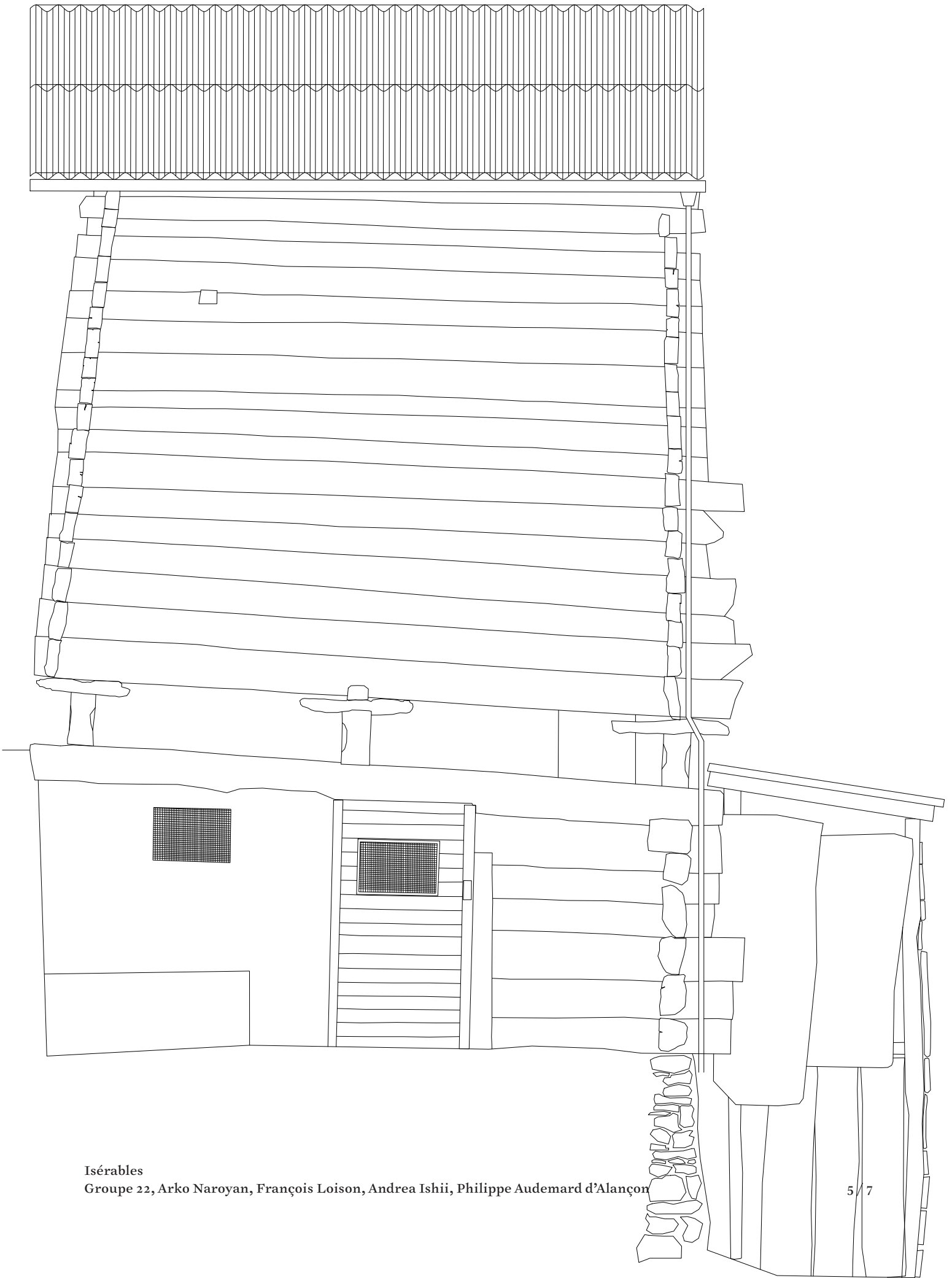

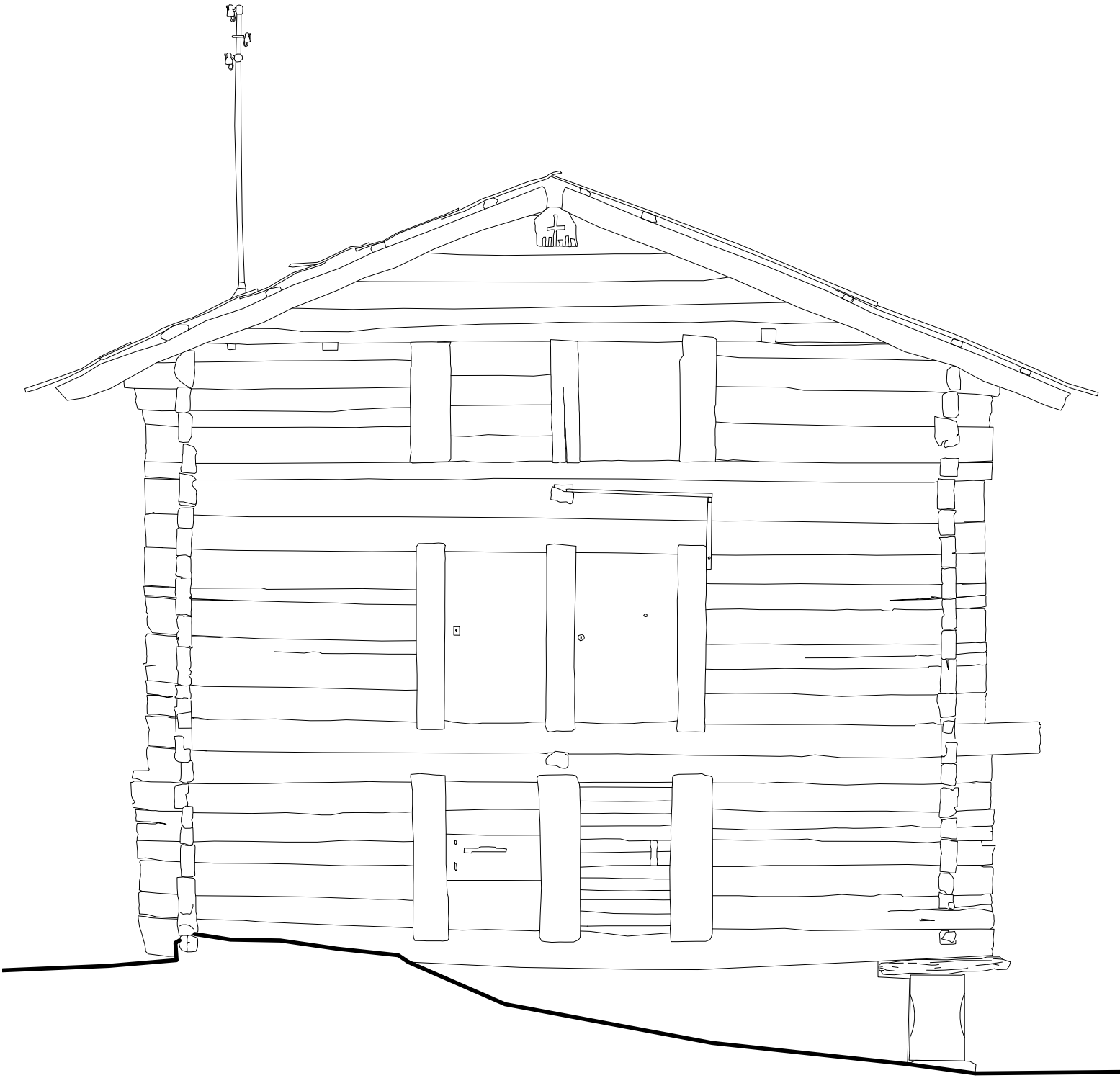

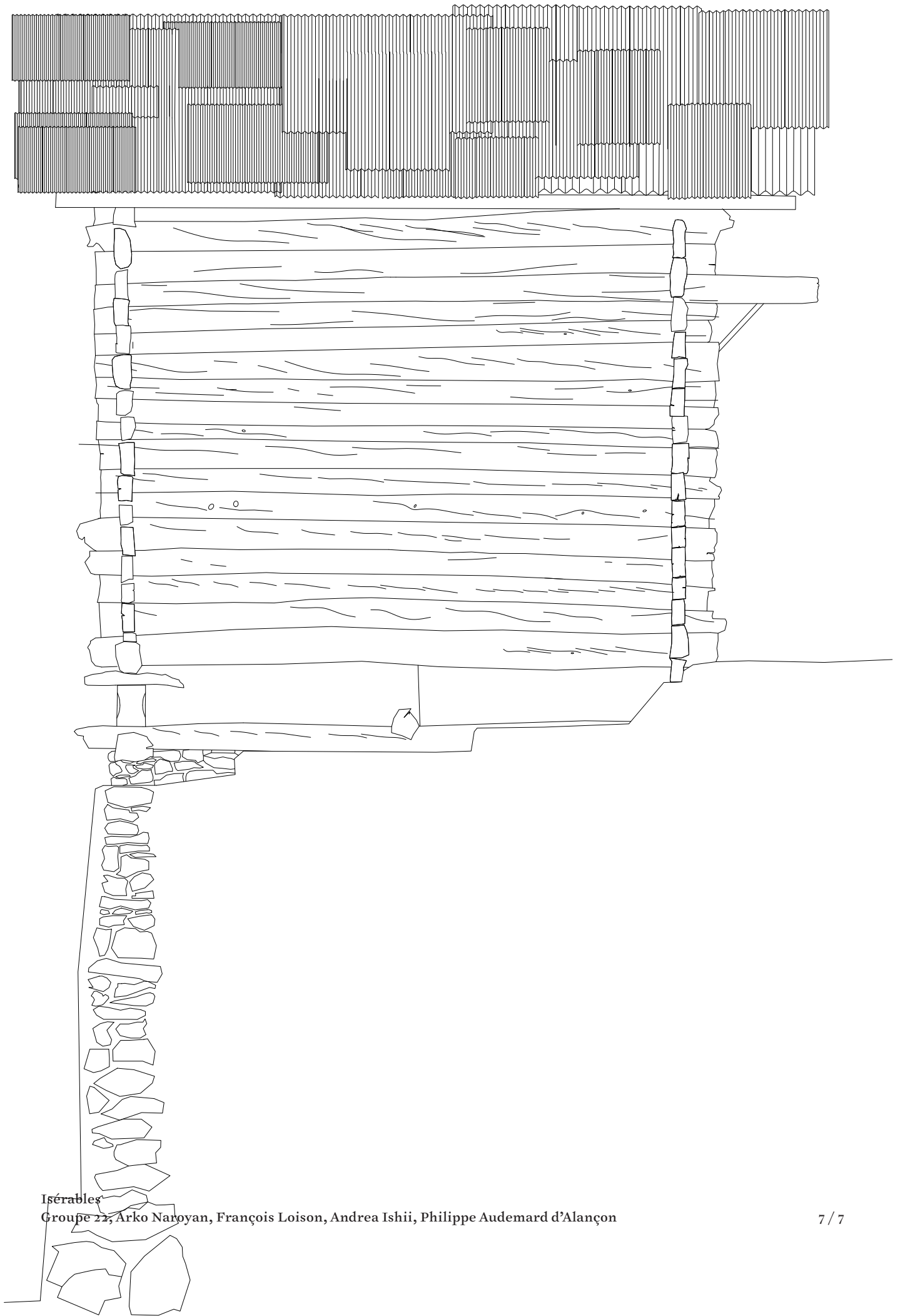

Iserables

Groupe 22, Arko Narayan, François Loison, Andrea Ishii, Philippe Audemard d'Alançon



