

Title project:

'Montreux Jazz Heritage Lab'

Project description:

The *Montreux Jazz Heritage Lab* is a habitable architectural module that allows the user to plunge into 45 years of jazz, blues and rock concerts in the form of digital archives. The shape of its projection surface, precisely curved in order to enhance embodied user experience, finds its precedents in *trompe l'œil* effects brought to excellence in the baroque age. This device therefore draws reference from a specific pictorial heritage, combining a corporeal experience of visual content with the archives of musical heritage. The collaboration with the acoustics laboratory LEMA at EPFL had a profound influence onto the geometry of the project and the materials used. The micro-perforated screen offers acoustics transparency, which permits the masking of speakers behind it whilst glass panels located behind the screen equally transmit light. The opening mechanism allows for a folding away of an entire wall as a door, thus allowing the device to be operated in two different modes: acoustically isolated for a small audience inside the space of the module, or open and accessible to a larger audience. Through its transparency and its capacity to modify its configuration, the module becomes an actor in a larger space in which it resides. This architectural module was developed at EPFL ECAL LAB in 2011-12.

Architect:

Dieter Dietz, Olivier Ottevaere, Charlotte Erckrath, Lukas Lenherr, Tibo Smith, Christopher Tan, Alexander Hertel, ALICE EPFL

Address:

BP 4120 Station 16, 1015 Lausanne
Tél. +41 (0)21 693 32 03, Fax +41 (0)21 693 32 25
<http://alice.epfl.ch>, jaime.ruiz@epfl.ch

Interaction design:

Nicolas Henchoz, Cem Sever, Daniel Tamburino, EPFL + ECAL LAB

Address:

11, Avenue du 24-Janvier, CH-1020 Renens
Tél. +41 (0)21 693 08 04, Fax +41 (0)21 693 08 11
www.epfl-ecal-lab.ch/
info@epfl-ecal-lab.ch

Coordination of the Montreux Jazz Digital Project:

MetaMedia Center, EPFL

Partner:

Montreux Jazz Festival

EPFL Scientific Labs:

Laboratory of Electromagnetics and Acoustics
Audiovisual communication Laboratory
Signal Processing Laboratory 2

Support:

Mr Vasily Shahnovskiy
Mrs Theresa Rydge
Audemars Piguet SA
Lombard Odier Darier Hentsch & Cie

Technological Partners:

3D audio system : Illusonic (Lausanne)

Loudspeakers : Relec (Yverdon-les-Bains)

Acoustic glas : Glas Troesch (Bützberg / Bussigny VD)

Interactive table : to-fuse (Zürich)

Year: 2012

Photo credits: see photosheets



filename: 01_joel tettamanti_view exterior.tif
© Joel Tettamanti / ALICE Studio EPFL

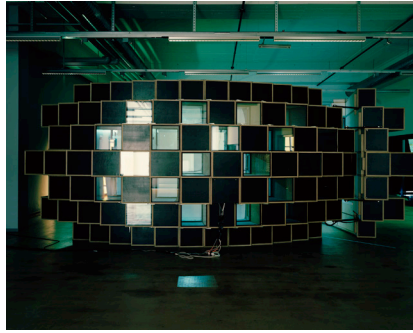

filename: 02_joel tettamanti_view exterior.tif
© Joel Tettamanti / ALICE Studio EPFL

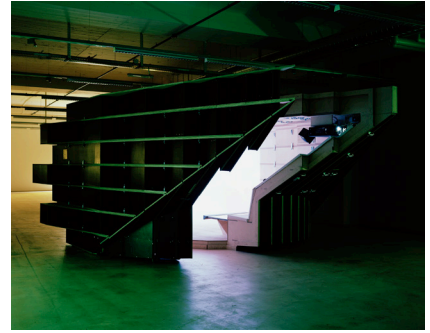

filename: 03_joel tettamanti_view exterior.tif
© Joel Tettamanti / ALICE Studio EPFL



filename: 04_joel tettamanti_view exterior.tif
© Joel Tettamanti / ALICE Studio EPFL

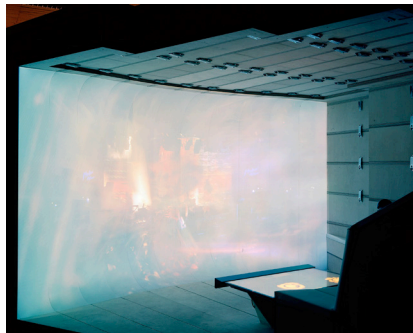

filename: 05_joel tettamanti_view interieur.tif
© Joel Tettamanti / ALICE Studio EPFL

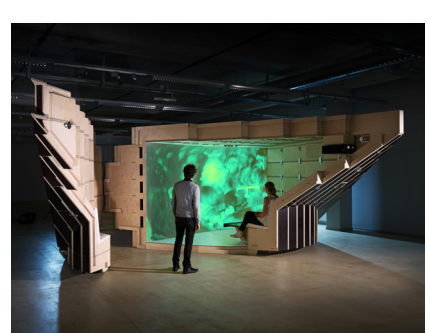

filename: 06_ECALEPFLLAB_view exterior.jpg
© Daniela Droz, Tonatiuh Ambrosetti / ALICE Studio EPFL + ECAL Lab



filename: 07_ECALEPFLLAB_view exterior.jpg
© Daniela Droz, Tonatiuh Ambrosetti / ALICE Studio EPFL + ECAL Lab

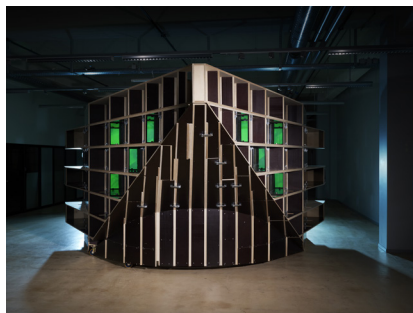

filename: 08_ECALEPFLLAB_view exterior.jpg
© Daniela Droz, Tonatiuh Ambrosetti / ALICE Studio EPFL + ECAL Lab

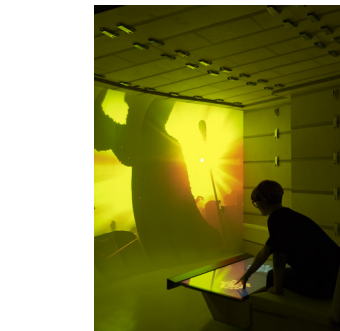

filename: 09_ECALEPFLLAB_view interieur.jpg
© Daniela Droz, Tonatiuh Ambrosetti / ALICE Studio EPFL + ECAL Lab



filename: 10_ECALEPFLLAB_view interieur.jpg
© Daniela Droz, Tonatiuh Ambrosetti / ALICE Studio EPFL + ECAL Lab



filename: 11_MJHL_construction_1.jpg
© ALICE Studio EPFL + ECAL Lab



filename: 12_MJHL_construction_2.jpg
© ALICE Studio EPFL + ECAL Lab



filename: 13_MJHL_construction_3.jpg
 © ALICE Studio EPFL + ECAL Lab

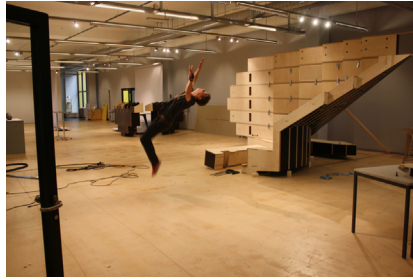

filename: 14_MJHL_construction_4.jpg
 © ALICE Studio EPFL + ECAL Lab



filename: 15_MJHL_construction_5.jpg
 © ALICE Studio EPFL + ECAL Lab



filename: 16_MJHL_construction_6.jpg
 © ALICE Studio EPFL + ECAL Lab



filename: 17_MJHL_construction_7.jpg
 © ALICE Studio EPFL + ECAL Lab



filename: 18_layout_cutting_boards.jpg
 © ALICE Studio EPFL + ECAL Lab

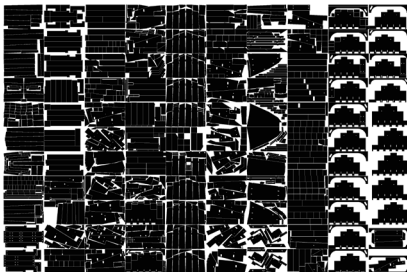

filename: MJF_ALL_BOARDS.png
 caption: layout cutting boards
 © ALICE Studio EPFL + ECAL Lab

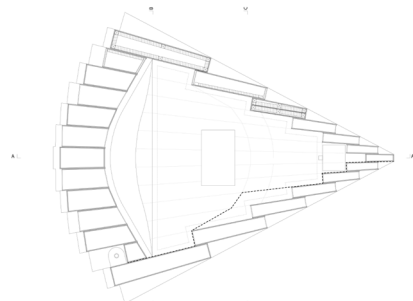

filename: B1_plan_closed.png
 caption: plan closed
 © ALICE Studio EPFL + ECAL Lab

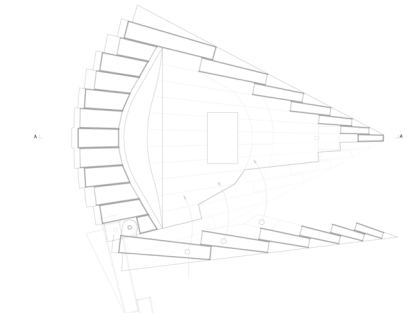

filename: B2_plan_open.png
 caption: plan open
 © ALICE Studio EPFL + ECAL Lab

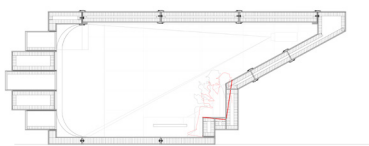

filename: B3_section_A-A'.png
 caption: section A-A'
 © ALICE Studio EPFL + ECAL Lab

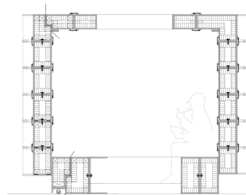

filename: B4_section_B-B'.png
 caption: section B-B'
 © ALICE Studio EPFL + ECAL Lab

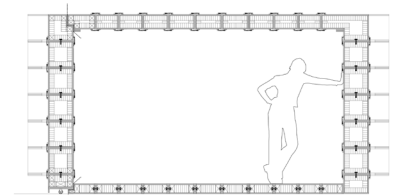

filename: B5_section_C-C'.png
 caption: section C-C'
 © ALICE Studio EPFL + ECAL Lab

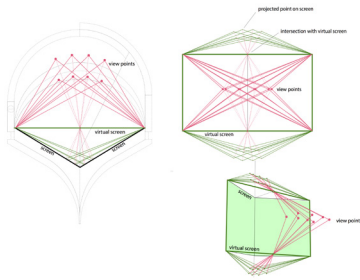

filename: perspective perception of projection.png
caption: perspective perception of projection
© ALICE Studio EPFL + ECAL Lab

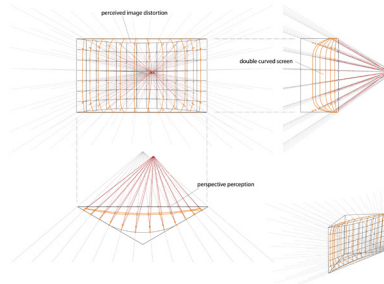

filename: projection of a distorted grid.png
caption: projection of a distorted grid
© ALICE Studio EPFL + ECAL Lab

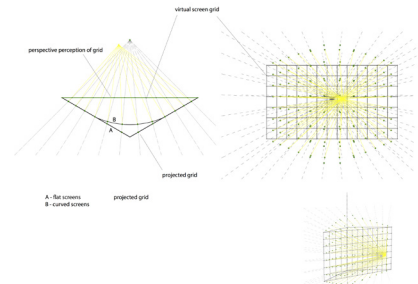

filename: projection of a grid.png
caption: projection of a grid
© ALICE Studio EPFL + ECAL Lab

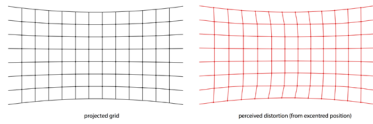

filename: grid.png
caption: projection grids
© ALICE Studio EPFL + ECAL Lab